

INSET
SCALE: 1"=30'

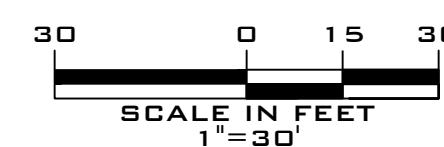

LEGEND

- CONC. MONUMENT
- IRON PIN
- BOLLARD
- CLEANOUT
- ⊕ FIRE HYDRANT
- ⊕ GAS VALVE
- ⊕ GUP WIRE
- ⊕ 4" INLET
- ⊕ 6" INLET
- ⊕ 8" INLET
- LIGHT POLE
- ⊕ MAILBOX
- ⊕ SANITARY MANHOLE
- ⊕ SIGN
- ⊕ SPOT ELEVATION
- ⊕ STORM MANHOLE
- TREE
- ⊕ UNKNOWN MANHOLE
- ⊕ UTILITY POLE
- ⊕ UTILITY POLE W/LIGHT
- ⊕ WATER METER
- ⊕ ELEC. TRANSFORMER

- 1' CONTOUR INTERVAL
- 5' CONTOUR INTERVAL
- CURB
- EDGE OF PAVEMENT
- EDGE OF STONE
- CHAIN LINK FENCE
- VINYL FENCE
- WIRE FENCE
- WOOD FENCE
- GAS LINE
- PROPERTY LINE
- STORM LINE
- SANITARY LINE
- WOODS LINE

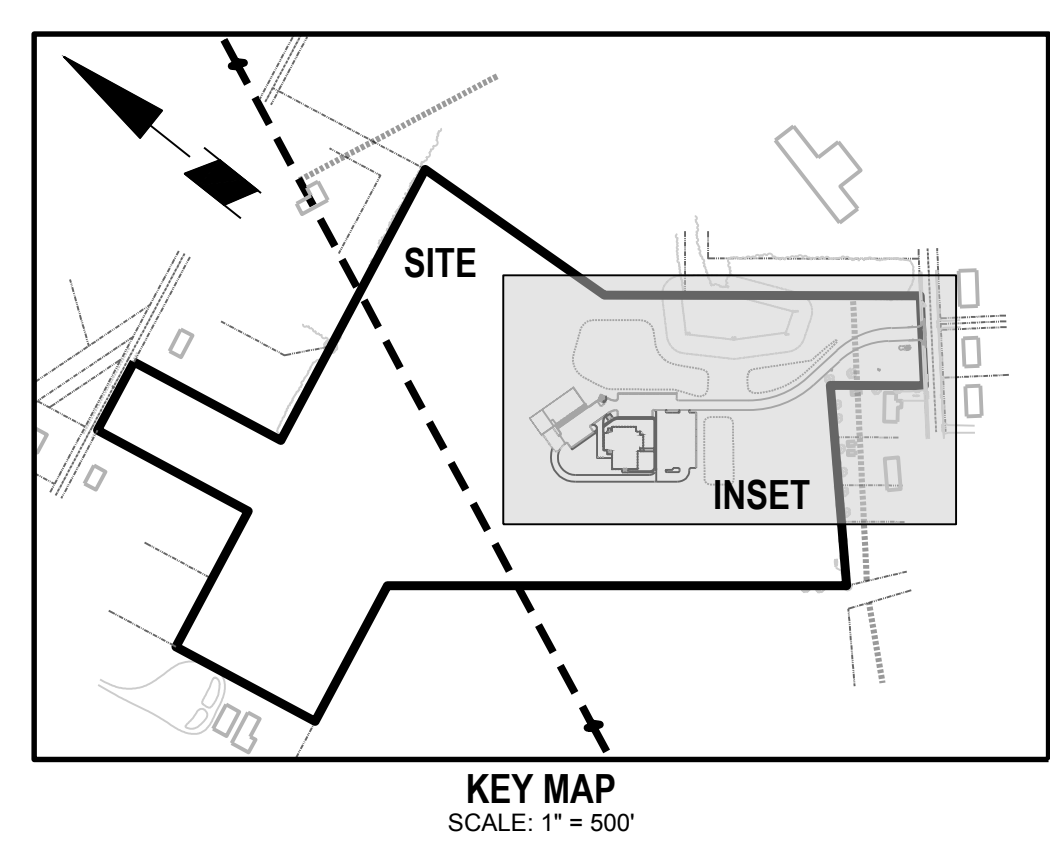

SITE PLAN

SITE PLANS FOR
FIRST BAPTIST CHURCH OF ELMER
 PLATE 6, BLOCK 12, LOTS 2.10 & 2.12
 329 FRONT STREET
 SITUATED IN THE
 BOROUGH OF ELMER
 COUNTY OF SALEM, STATE OF NEW JERSEY
SITE CIVIL ENGINEERING
 2205 DELSEA DRIVE, SUITE 7
 FRANKLINVILLE, NEW JERSEY 08322
 (908) 885-8679
 FAX (908) 513-6504
 N.J. CERTIFICATE OF AUTHORIZATION No. GA28188600

REV.	DATE	DESCRIPTION	BY

FILE NUMBER 934-2021	CHECKED BY: WG	DRAWN BY: MPG	SCALE: 1"=30'	PROJECT NO. 934	DATE: NOVEMBER 9, 2022	SHEET 5 OF 12
 WILLIAM P. GILMORE, P.E. NEW JERSEY PROFESSIONAL ENGINEER NO. 2460473100			11/09/22	DATE		